

DAIRY DISTRIBUTION MAP

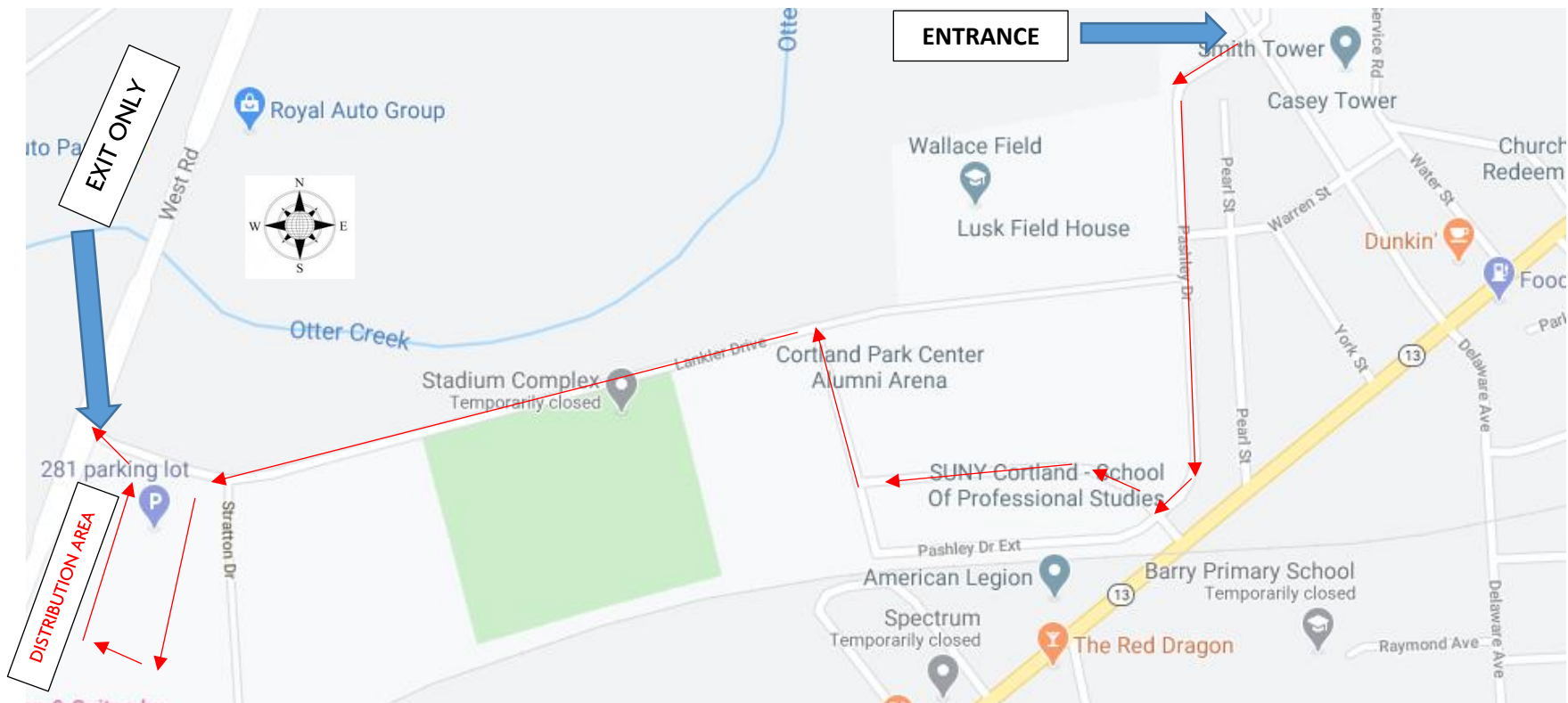

-ALL VEHICLES SHALL ENTER VIA **PASHLEY DRIVE** OFF OF **BROADWAY**

-ALL VEHICLES WILL BE DIRECTED BY SIGNAGE AND POLICE/FIRE PERSONNEL TO ENSURE AN ORDERLY FLOW OF TRAFFIC TO THE DISTRIBUTION AREA

****THE TOMPKINS ST ENTRANCE AND THE 281 ENTRANCE TO THE CAMPUS WILL BE "CLOSED"**



DAIRY DISTRIBUTION MAP